

235HSC - MARINE GEARBOX

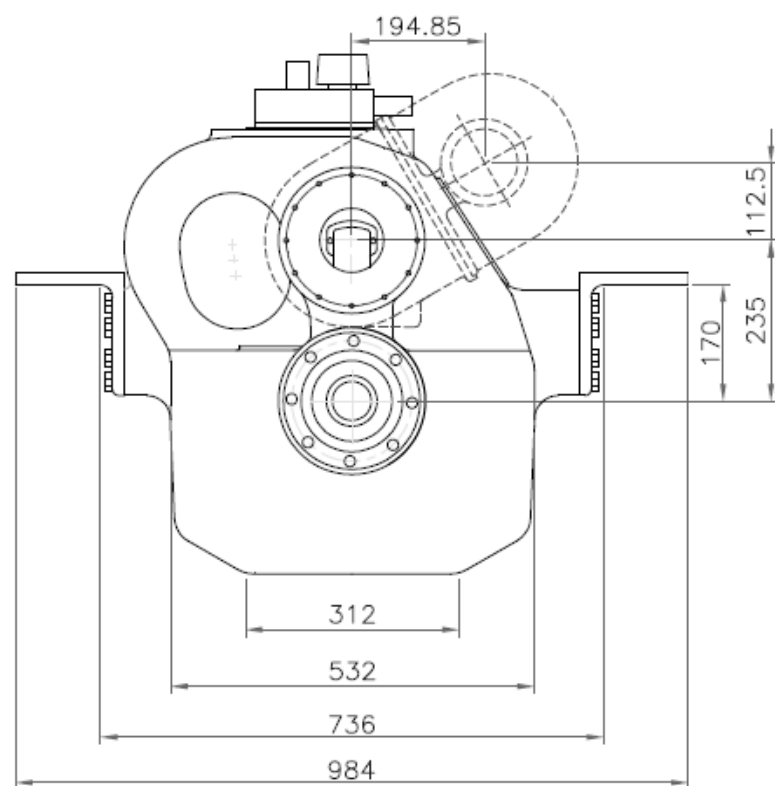
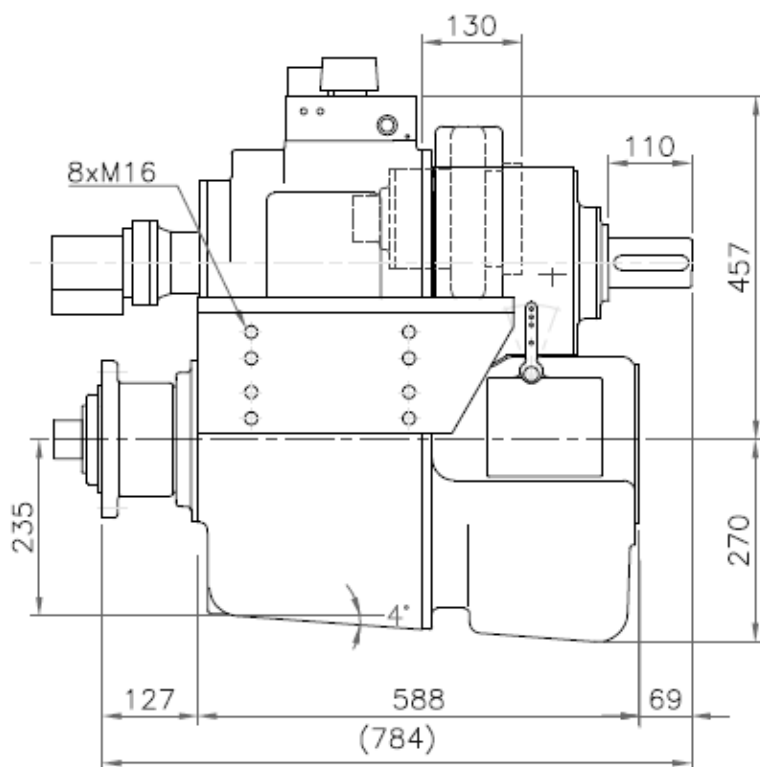

Assembly Type 235HSC

Reduction ratio	PW kW/rpm	Input shaft mm
1,96-2,45:1	0,350	65
2,94:1	0,310	65
3,43:1	0,226	65

Servo for CP Propeller:

Max force = 110 kN
Max stroke = 80 mm

PTO

PTO with SAE B-flange and 13 tooth $\frac{7}{8}$ " involute inside spline
Max torque from PTO: 600 Nm

Weight:

Approx. 400 kg

Gearbox:

- Built-in servo system for CP propeller
- Compact design
- Option of 1 PTO with own hydraulic clutch
- Rigid cast iron housing
- Helical ground gearwheels in casehardened and highly alloyed steel
- Hydraulic multi-plate clutch
- Oil system with direct driven oil pump, cooler, filter, valves etc.
- Pressure lubricated spherical roller bearings
- Designed according to the rules of the classification societies
- Each gearbox is tested and approved in test bed

Variants:

- 235HSC-IS with built-in intermediate shaft for counter rotating propeller
- 235HSC-U with U-drive
- 235HSC-U-IS with U-drive and intermediate shaft for counter rotating propeller