

430-2HS - MARINE GEARBOX

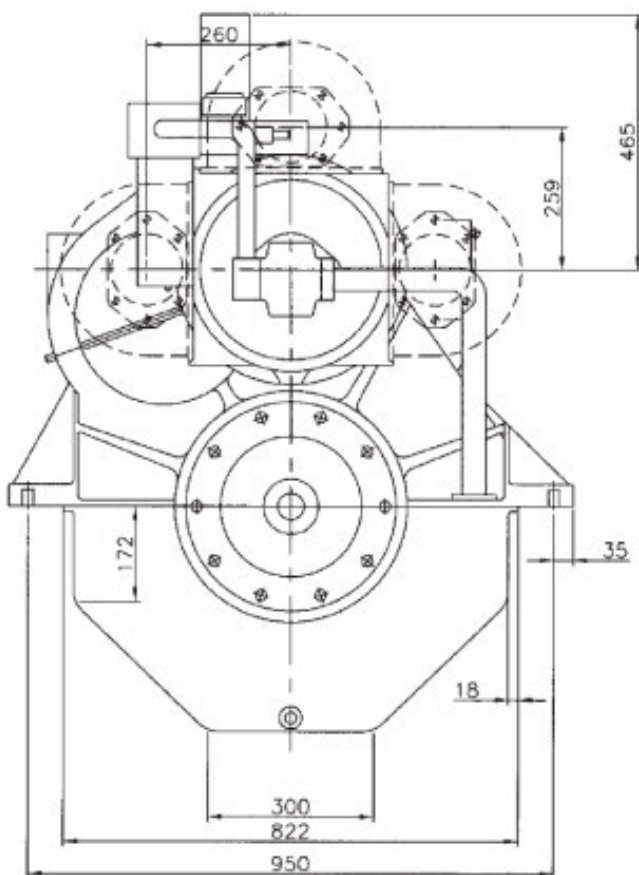
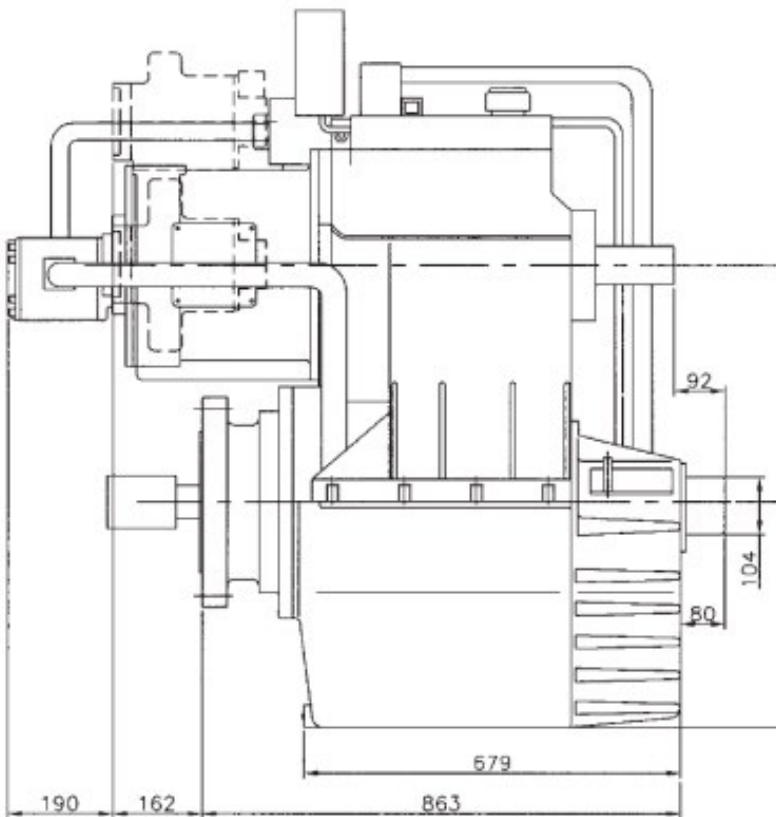

Assembly Type 430HS-2HS

Reduction ratio	PF kW/rpm	Input shaft mm
1,56-2,04-2,48-3,12-3,48:1	0,690	80
4,15-4,45-5,12:1	0,690	80
5,44:1	0,613	80
4,56-5,04:1	0,540	70
5,56:1	0,540	70
5,87:1	0,530	70
6,53:1	0,460	70

Servo for CP Propeller:

Max force = 200 kN

Max stroke = 124 mm

PTO:

PTO with SAE C-flange and 14 tooth 1 1/4" involute inside spline

Other SAE and ISO flanges and splines available

Free shaft end also available

Max torque from PTO: 900 Nm

Weight:

Approx. 1440 kg

Gearbox:

- Built-in servo system for CP propeller
- Compact design
- Large economical reduction ratio
- Option of 1, 2 or 3 PTOs each with own hydraulic clutch
- Rigid cast iron housing
- Helical ground gearwheels in casehardened and highly alloyed steel
- Hydraulic multi-plate clutch
- Oil system with direct driven oil pump, cooler, filter, valves etc.
- Pressure lubricated spherical roller bearings
- Designed according to the rules of the classification societies
- Each gearbox is tested and approved in test bed

Variants:

430-2OD prepared for OD system